

# IRRIGATION

Hose technology and accessories

Grünin **G+L**oske

[www.gruelo.de](http://www.gruelo.de)

*Your professional when it comes to hoses!*



*Reliable, for sure!*

★ friendly

★ flexible

★ fair

★ competent

★ reliable

5-STAR - SERVICE EVERY DAY!



For more than 60 years, Grünig & Loske GmbH has been standing for a successful combination of services and products in the business-to-business sector. Our declared intention is to turn our customers into delighted fans by our 5-Star-Service: friendly, flexible, fair, competent and reliable – from the first contact to on-time delivery!

As technical trade with own workshops we have decades of experience in the assembly of suction and pressure hoses for irrigation or groundwater lowering. From clamp binding or pressing of the hose line with all conceivable coupling systems to pressure testing of the hose line - we offer you a comprehensive portfolio of products and services with only one goal in mind. To make your everyday work easier.

In case you need more detailed information about a particular product or would like to get a general idea about our extensive assortment, please visit us on [www.gruelo.de](http://www.gruelo.de).

In case you need help to choose the right product for your application area our kind and competent sales team provides assistance under:

Fon: +49 (0)5102-9199-01

Fax: +49 (0)5102-9199-90

Mail: [info@gruelo.de](mailto:info@gruelo.de)

Enjoy our new range of products!

Dirk Loske  
CEO



[www.gruelo.de](http://www.gruelo.de)

## Assembled hose lines

Assembly is done under strong compliance with regulations applying to the manufacturing of complete hose lines according to European Pressure Equipment Directive PED 2014/68/EU. Our qualified specialist staff compresses your hose lines up to DN 12"/305 mm with all common coupling systems (Bauer, Perrot, Flange, clamping ring coupling, Victaulic).



**Water S/D 10**



**GrüloElastic SE**



**Hydroflex HD**

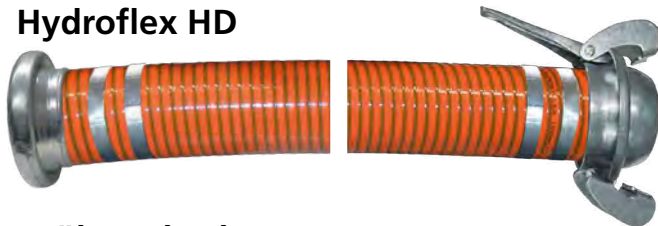

**GrüloElastic Oil AS**



**GrüloFaekaFlex**

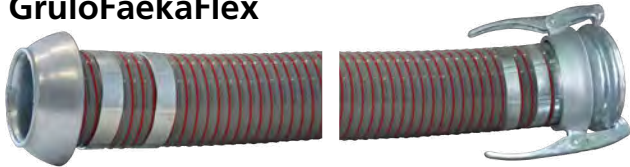

**Arizona Superelastic**

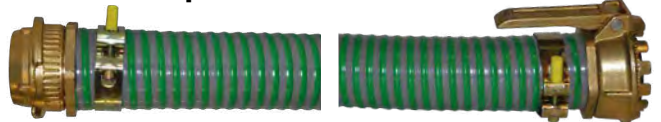

Tested in our own test, the grouting withstood a tensile force of at least 750 kg!

**GrüloChem SP EPDM**



**GrüloTank SP**



## Individual labelling

### HOSE MARKINGS

On request we can produce your hose line with a transfer tape in your corporate colour and logo.



Your company name could also appear here!

### LASER ENGRAVING

We mark your assembled hose lines with our in-house laser. Thus, manufacturer name and order number are visible at a glance. Likewise Customer-specific specifications are possible.

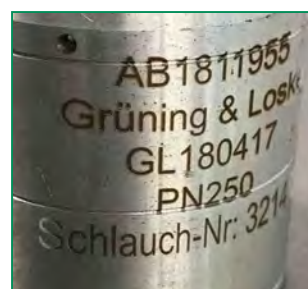



## GrüloDur Multipurpose layflat hose

Flat hose for the delivery of liquid media - as well as hot water and compressed air. Abrasion resistant, robust and long-lasting. Resistance to oil, petrol and chemicals. Lightweight and very flexible compared to mandrel built hoses.

All technical data refer to a temperature of 20 °C.

### Technical characteristics

Temperature range: -15 °C to +100 °C

Standard length: 100 m | further lengths on request

Colour: Black



### Construction

Cover: NBR/PVC compound, ribbed

Reinforcement: Polyester, circular woven

Lining: NBR/PVC compound, black, smooth

Inner mm	Inner Inch	Wall mm	WP bar	BP bar	Weight kg/m	Article no.
52	2	2,00	20	60	0,460	10009-052
75	3	2,50	17	50	0,790	10009-075
90	3 1/2	2,35	15	45	0,930	10009-090
102	4	2,50	17	52	1,030	10009-102
125	5	2,70	15	45	1,400	10009-125
152	6	2,60	14	42	1,650	10009-152

## Synthetic building hose Standard Layflat hose with couplings

Efficient layflat hose with Storz suction couplings for water pumping.

Hose binding according to your requirements.

### Technical characteristics

Temperature range: -30 °C to +100 °C | information valid for water

Standard length: 20 m | further lengths on request

Colour: White



### Construction

Material: Polyester yarn, circular woven in twill weave

Lining: EPDM rubber

Inner mm	Inner Inch	Wall mm	WP bar	BP bar	Weight kg/Piece	Article no.
C/52	2	1,70	16	50	8,000	90002-052-020
B/75	3	1,70	16	50	11,500	90002-075-020
A/102	4	2,10	10	30	14,000	90002-102-020
F/152	6	2,10	10	30	27,000	90002-152-020

## GrüloDur PU

### Multipurpose layflat hose in PU

Layflat hose for the delivery of liquids under pressure and for transport of abrasive materials, superior abrasion resistance, extremely hardwearing and durable for long service life, resistance to oil, fuel and a wide range of chemicals, excellent flexibility at low temperature.

All technical data refer to a temperature of 20 °C.

#### Technical characteristics

Temperature range: -50 °C to +75 °C | information valid for water  
 Standard length: 100 m | further lengths on request  
 Colour: Black

#### Construction

Cover: Polyether polyurethane, smooth  
 Reinforcement: High-strength polyester yarn, round woven  
 Lining: Polyether polyurethane, smooth

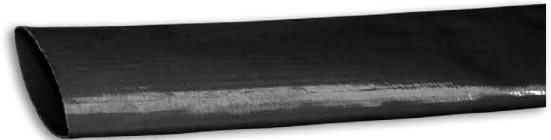

Inner mm	Inner Inch	Wall mm	WP bar	BP bar	Weight kg/m	Article no.
52	2	2,40	16	50	0,430	10023-052
76	3	2,80	16	50	0,700	10023-076
90	3 1/2	2,90	14	42	0,950	10023-090
102	4	3,30	14	42	1,150	10023-102
127	5	3,40	14	42	1,500	10023-127
152	6	3,70	14	42	1,900	10023-152

## GrüloFlat M

### PVC layflat hose, medium duty

Medium duty layflat hose for conveying liquid media. Flat rollable. For the use in irrigation systems, construction industry, agriculture and mining.

All technical data refer to a temperature of 20 °C.

#### Technical characteristics

Temperature range: -10 °C to +60 °C | information valid for water  
 Standard length: 100 m | further lengths on request  
 Colour: Blue

#### Construction

Cover: PVC  
 Reinforcement: Polyester yarn  
 Lining: PVC, blue



Inner mm	Inner Inch	WP bar	BP bar	Weight kg/m	Article no.
51	2	6	18	0,300	10005-050
76	3	6	18	0,550	10005-076
102	4	6	18	0,900	10005-102
153	6	6	18	1,800	10005-150
203	8	6	18	2,800	10005-203

## GrüloFlat PUR Pro

### Robust multi-purpose hose

Suitable for conveying abrasive media, e.g. as suction dredging hose for long distances or for roof graveling. Outstanding abrasion resistance, very robust, wear-resistant and durable, extremely high tensile strength, resistant to oil, petrol and chemicals. Furthermore it is much easier to handle compared to rubber hoses.

#### Technical characteristics

Temperature range: -50 °C to +75 °C | information valid for water  
 Standard length: 100 m, 200 m  
 Colour: Orange

#### Construction

Cover: TPU, smooth  
 Reinforcement: High-strength polyester yarn, round woven  
 Lining: TPU, smooth



Inner mm	Inner Inch	Wall mm	WP bar	BD bar	Weight kg/m	Article no.
75	3	3,10	20	50	0,870	11042-076
90	3 1/2	3,50	14	42	1,200	11042-090
102	4	3,30	14	42	1,300	11042-102
127	5	3,30	14	42	1,500	11042-127
152	6	3,50	12	36	2,000	11042-152

## Water S/D 10

### Rubber suction and delivery hose

**Water S/D** is ideally suited for construction, agriculture and industry, for irrigation and drainage. The core is resistant to sewage, slurry, drilling mud and slightly abrasive media. The abrasion-resistant cover offers a good resistance to weathering.

Available in lengths of 3 or 5 m and with spiral free cuffs!



#### Technical characteristics

Temperature range: -25 °C to +70 °C

Standard length: 40 m | further lengths on request

Colour: Black

#### Construction

Cover: SBR, with fabric impression

Reinforcement: Synthetic textile, steel wire spiral

Lining: SBR, black, smooth

Inner mm	Inner Inch	Wall mm	WP bar	BP bar	Vakuum bar	BR mm	Weight kg/m	Article no.
51	2	5,50	10	30	0,9	306	1,738	10056-051
76	3	6,50	10	30	0,9	458	2,845	10056-076
90	3 1/2	6,50	10	30	0,9	542	3,800	10056-090
102	4	6,50	10	30	0,9	610	3,930	10056-102
152	6	8,50	10	30	0,9	915	7,850	10056-152
203	8	11,00	10	30	0,9	1219	13,500	10056-203
254	10	12,50	10	30	0,9	1524	18,240	10056-254
305	12	12,00	10	30	0,9	1829	21,400	10056-305

## Vacupress® Flex

### Highly flexible suction and delivery hose

Highly flexible universal hose with good weather- and abrasion resistance according to DIN 53516 (mm<sup>3</sup><160) even at temperatures below zero. **Vacupress® Flex** is ideally suited as suction and discharge hose for sewer cleaning vehicles and silo trucks.



#### Technical characteristics

Temperature range: -25 °C to +60 °C

Standard length: 60 m | from DN 38: 30 m, from DN 127: 20 m

Colour: Black

#### Construction

Cover: PVC, smooth

Reinforcement: Embedded steel wire spiral, polyester yarn

Lining: PVC, black, smooth

**MERLETT**

Inner mm	Inner Inch	Outer mm	WP bar	BP bar	Vakuum bar	BR mm	Weight kg/m	Article no.
50	2	64	12	36	0,90	150	1,600	10053-050
76	3	92	12	36	0,90	210	2,970	10053-076
80	-	96	10	30	0,90	220	3,020	10053-080
102	4	119	10	30	0,90	300	4,150	10053-102
127	5	145	7	22	0,90	370	5,950	10053-127
152	6	171	5	15	0,90	480	7,050	10053-152

## Deltaflex

### Rubber suction hose with spiral-free sleeves on both sides

Very flexible suction and pressure hose for process water, liquid manure, light acids and alkalis.



**GrüloLine**

#### Technical characteristics

Temperature range: -30 °C to +80 °C

Standard length: 3 m

Colour: Black

#### Construction

Cover: SBR, corrugated, fabric patterned

Reinforcement: Embedded steel wire spiral

Lining: SBR, smooth

Inner mm	Inner Inch	Wall mm	WP bar	Vakuum bar	BR mm	Article no.
152	6	9	3	0,9	532	10341-150-3000
203	8	11	3	0,9	711	10341-200-3000

## GrüloVin

### PVC suction hose, transparent

Robust, flexible and abrasion resistant PVC hose, usable as suction hose for water, foodstuff, beverages up to 28 Vol.-% of alcohol, drinking water, for vacuum pumps and groundwater drawdown. Very good chemical resistance.

All technical data refer to a temperature of 20 °C.

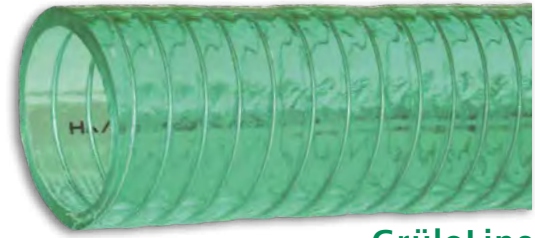

GrüloLine

#### Technical characteristics

Temperature range: -5 °C to +60 °C

Standard length: 30 m

Colour: Green transparent

#### Construction

Cover: Soft PVC, smooth

Reinforcement: Embedded steel wire spiral

Lining: Soft PVC, smooth

Inner mm	Inner Inch	WP bar	BP bar	Vakuu bar	BR mm	Weight kg/m	Article no.
51	2	3	9	0,8	125	1,200	10248-050
76	3	2	6	0,7	195	2,500	10248-075
90	3 1/2	2	6	0,6	260	3,000	10248-090
102	4	2	6	0,6	300	3,400	10248-102
127	5	2	6	0,6	385	4,700	10248-125
152	6	2	6	0,6	460	6,350	10248-152

## GrüloFaekaFlex

### Flexible PVC suction and discharge hose

Highly flexible suction and delivery hose with rigid PVC spiral for municipal use, irrigation and on the agricultural sector. Very good flexibility, even at low temperatures, high resistance against abrasion and many chemicals.

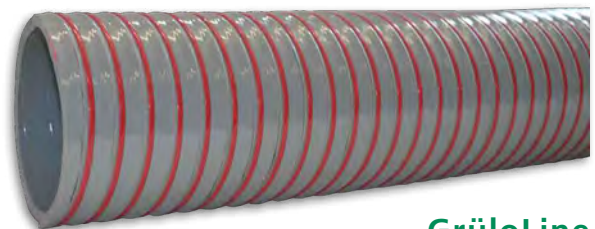

GrüloLine

#### Technical characteristics

Temperature range: -25 °C to +60 °C

Standard length: 50 m | DN 127: 30 m, DN 152: 20 m, DN 203: 10 m

Colour: Grey, red spiral strip

#### Construction

Cover: PVC, slightly corrugated

Reinforcement: Rigid PVC spiral, impact and pressure resistant

Lining: PVC, smooth

Inner mm	Inner Inch	Outer mm	WP bar	Vacuun bar	BR mm	Weight kg/m	Article no.
51	2	60,4	6,0	0,85	302	1,030	12072-051
76	3	87,6	5,0	0,85	438	1,750	12072-076
80	-	91,8	4,5	0,85	459	1,845	12072-080
102	4	115	4,5	0,80	575	2,650	12072-102
127	5	141	3,5	0,80	705	3,540	12072-127
152	6	167,6	3,0	0,80	838	5,000	12072-152
203	8	222,0	2,5	0,80	1.110	8,400	12072-203



## Hose assembly and pressure testing according to DGRL 2014/68/EU

As a certified specialist workshop, we assemble your hose lines according to the latest state of the art. All hose lines are tested and you will receive a test certificate afterwards.

#### Overview of our services:

- Assembly of your hose line
- Hose testing according to BetrSichV and DGRL 2014/68/EU
- Individual marking
- Documentation according to EN 10204
- Mobile service on site for recurring inspection of the hose line



# STORZ COUPLINGS

**Technical characteristics**

**Material:** Aluminium | also available in brass  
**Seal:** Nitrile rubber, black/white

**Thread:** DIN ISO 228  
**WP:** 16 bar/10 bar

## Suction hose coupling

Storz	KA mm	D mm	L mm	Remark	Weight/piece kg	Article no.
52-C	66	52	90	DIN 14321	0,370	21015-052-052-01
75-B	89	75	125	DIN 14322	0,710	21015-075-075-01
90	105	90	160	-	1,090	21015-090-090-01
110-A	133	110	170	DIN 14323	1,660	21015-110-110-01
125	148	125	200	-	2,270	21015-125-125-01
150	160	150	180	-	2,900	21015-150-150-01
205	220	205	375	max. PN 10	7,200	21015-205-205-01

KA = Lug space

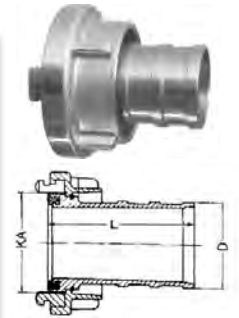

## Adapter with female thread

Storz	KA mm	Female thread Inch	Remark	Weight/piece kg	Article no.
52-C	66	2	DIN 14307	0,280	21020-052-20-01
75-B	89	2 1/2	DIN 14308	0,420	21020-075-24-01
		3	-	0,420	21020-075-30-01
90	105	3	-	0,600	21020-090-30-01
110-A	133	4 1/2	DIN 14309	1,120	21020-110-44-01
125	148	5	-	1,380	21020-125-50-01
150	160	6	-	1,820	21020-150-60-01
205	220	8	max. PN 10	3,480	21020-205-80-01

KA = Lug space

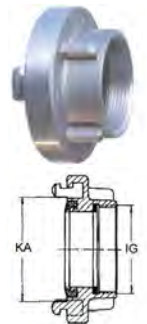

## Adapter with male thread

Storz	KA mm	Female thread Inch	Remark	Weight/piece kg	Article no.
52-C	66	1 1/2	-	0,250	21021-052-14-01
		2	-	0,210	21021-052-20-01
75-B	89	2 1/2	-	0,360	21021-075-24-01
		3	-	0,390	21021-075-30-01
90	105	3	with nipple	0,800	21021-090-30-01
110-A	133	4	-	1,010	21021-110-40-01
125	148	5	with nipple	1,810	21021-125-50-01
150	160	6	with nipple	2,340	21021-150-60-01

KA = Lug space



## Reducer Storz to Storz

Storz	KA mm	Remark	Weight/piece kg	Article no.
52-C / 25-D	66 / 31	DIN 14341	0,310	21040-052-025-01
75-B / 52-C	89 / 66	DIN 14342	0,600	21040-075-052-01
110-A / 75-B	133 / 89	DIN 14343	1,570	21040-110-075-01
125 / 100	148 / 115	-	2,630	21040-125-100-01
150 / 110-A	160 / 133	-	4,850	21040-150-110-01
150 / 125	160 / 148	-	3,960	21040-150-125-01

KA = Lug space

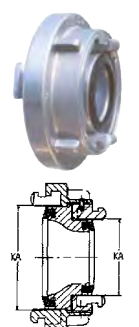



## Blank cap with chain

Storz	KA mm	Remark	Weight/piece kg	Article no.
52-C	66	DIN 14311	0,380	21030-052-01DIN
75-B	89	DIN 14312	0,560	21030-075-01DIN
110-A	133	DIN 14313	1,340	21030-110-01DIN
125	148	-	1,700	21030-125-01
150	160	-	2,140	21030-150-01

KA = Lug space

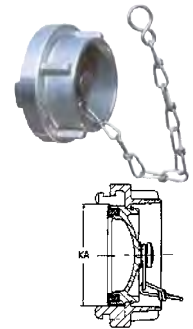

## Hose Couplings for segmented bindings

Storz	KA mm	D mm	L mm	Remark	Weight/piece kg	Article no.
52-C	66	52	81	without segm. binding	0,370	21014-052-052-01
75-B	89	75	85	without segm. binding	0,580	21014-075-075-01
90	105	90	80	without segm. binding	0,830	21014-090-090-01
110-A	133	110	88	without segm. binding	1,370	21014-110-110-01
125	148	127	90	without segm. binding	1,660	21014-125-127-01
150	160	150	101	without segm. binding	2,320	21014-150-150-01

KA = Lug space



## Segmented bindings for above couplings

Storz	IG Inch	Hose wall thickness	Weight/piece kg	Article no.
52	2	2 mm	0,410	21114-052-01
75	3	2,8 mm - 3,2 mm	0,550	21114-075-01
90	3 1/2	2,8 mm - 3,2 mm	0,630	21114-090-300-01
110	4 1/2	2,8 mm - 3,2 mm	0,730	21114-110-01
127	5	2,8 mm - 3,2 mm	0,860	21114-127-01
150	6	2,8 mm - 3,2 mm	1,520	21114-150-01

KA = Lug space



# CARDAN COUPLINGS SYSTEM PERROT

**Technical characteristics**

Material: Steel, galvanised | also available in stainless steel

Seal: Material according to requirements

## Male part with beaded hose shank

Also available with smooth, turned or serrated hose shank.

DN mm	Hose shank mm	Weight/piece kg	Article no.
50	50	0,420	23300-050-050-04
89	75	1,040	23300-089-075-04
108	100	1,620	23300-108-100-04
133	125	2,040	23300-133-125-04
159	150	2,700	23300-159-150-04
216	200	8,550	23300-216-200-04



## Female part with beaded hose shank

Also available with smooth, turned or serrated hose shank.

DN mm	Hose shank mm	Weight/piece kg	Article no.
50	50	0,980	23301-050-050-04
89	75	1,600	23301-089-075-04
108	100	2,820	23301-108-100-04
133	125	4,020	23301-133-125-04
159	150	8,080	23301-159-150-04
216	200	20,750	23301-216-200-04



### Male part with male thread

DN mm	Thread Inch	Article no.
50	2	23310-050-20-04
89	3	23310-089-30-04
108	4	23310-108-40-04
133	5	23310-133-50-04
159	6	23310-159-60-04



### Female part with male thread

DN mm	Thread Inch	Article no.
50	2	23311-050-20-04
89	3	23311-089-30-04
108	4	23311-108-40-04
133	5	23311-133-50-04
159	6	23311-159-60-04



### Male part with female thread

DN mm	Thread Inch	Article no.
50	2	23355-050-20-04
89	3	23355-089-30-04
108	4	23355-108-40-04
159	6	23355-159-60-04



### Female part with female thread

DN mm	Thread Inch	Article no.
50	2	23357-050-20-04
89	3	23357-089-30-04
108	4	23357-108-40-04
159	6	23357-159-60-04



### Reducer male to female part

DN female part mm	DN male part mm	Article no.
89	50	23336-050-089-04
108	89	23336-089-108-04
159	108	23336-108-159-04



### Expansion male to female part

DN female part mm	DN male part mm	Article no.
50	89	23337-089-050-04
89	108	23337-108-089-04
108	159	23337-159-108-04



## Inverter male - male

DN mm	Article no.
50	23338-050-050-04
89	23338-089-089-04
108	23338-108-108-04
133	23338-133-133-04
159	23338-159-159-04



## Inverter female - female

DN mm	Article no.
50	23339-050-050-04
89	23339-089-089-04
108	23339-108-108-04
133	23339-133-133-04
159	23339-159-159-04



## Quick-coupling pipes made of steel

### Technical characteristics

- Material:** Pipes made of steel strip, longitudinally welded and hot-dip galvanized. Coupling body and lever mechanism made of sheet steel, both black or hot-dip galvanized.
- Norm:** Hot-dip galvanizing according to DIN 2444. Technical delivery conditions for quick coupling pipes (diameter, wall thickness, corrosion resistance pressure etc.) according to DIN 19651.
- WP:** WP up to 10 bar, higher pressures on request.
- Angulation:** 15° in any direction.
- Standard length:** 2 to 6 m
- Diameter:** 50 / 70 / 89 / 108 / 133 / 159 mm



## PE pipes with cardan quick couplings

### Technical characteristics

- Application:** For ground water lowering
- Press-in rings:** Stainless steel, 2 pieces per coupling
- Max. WP:** 10 bar
- Standard length:** 6 m

### Attention:

The pipe length and the expansion of the pipes are subject to changes due to temperature fluctuations.

From DN 250 system Anfor (ital. system)



## BALL VALVES

### Technical characteristics

Norm Thread: ISO 228

Material: Pressed brass 58, nickelplated

Material seal: PTFE / Teflon

Temperature: -20 °C to +150 °C | according to working pressure

Also available in stainless steel and with cast iron lever

### female / female

DN Inch	DN mm	WP bar	L mm	I mm	A mm	B mm	C mm	SW mm	Weight/unit kg	Article no.
3/8	10	40	42	10	73	40	21	20	0,290	25001-03-02
1/2	15	40	52	12	84	48	25	25	0,174	25001-04-02-40
3/4	20	40	55	12	98	52	28	31	0,251	25001-06-02
1	24	32	68	15	102	59	34	40	0,433	25001-10-02
1 1/4	32	25	76	15	122	71	38	48	0,628	25001-12-02
2	50	20	106	19	173	92	53	67	1,556	25001-20-02
2 1/2	63	16	130	22	226	115	65	80	2,443	25001-24-02
3	75	16	146	26	226	125	73	98	3,876	25001-30-02
4	100	16	212	43	335	143	105	124	8,640	25001-40-02

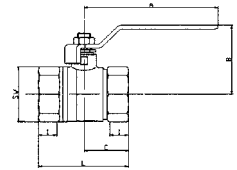

### female / male

DN Inch	DN mm	WP bar	L mm	li mm	la mm	A mm	B mm	C mm	SW mm	Weight/unit kg	Article no.
3/8	10	40	50	10	10	73	40	25	20	0,131	25002-03-02
1/2	15	40	59	12	12	84	48	30	26	0,193	25002-04-02
3/4	20	40	62	12	12	84	52	32	31	0,277	25002-06-02
1 1/4	32	25	91	15	19	122	71	46	48	0,672	25002-12-02
1 1/2	40	20	103	15	19	153	87	51	55	0,999	25002-14-02
2	50	16	123	19	24	173	92	64	67	1,732	25002-20-02

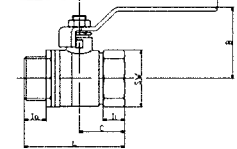

### Wing handle, female / female

DN Inch	DN mm	WP bar	L mm	I mm	A mm	B mm	C mm	SW mm	Weight/unit kg	Article no.
1/4	10	40	42	10	52	37	21	20	0,116	25004-02-02
3/8	10	40	42	10	52	37	21	20	0,105	25004-03-02
1/2	15	40	50	12	52	39	25	26	0,159	25004-04-02
3/4	20	40	55	12	52	45	28	32	0,236	25004-06-02
1	25	32	68	15	62	50	34	39	0,405	25004-10-02

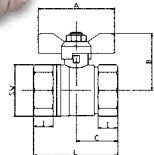

### Wing handle, female / male

DN Inch	DN mm	WP bar	L mm	li mm	la mm	A mm	B mm	C mm	SW mm	Weight/unit kg	Article no.
3/8	10	40	47	10	10	52	36	25	20	0,109	25005-03-02
1/2	15	40	59	12	12	52	41	30	26	0,160	25005-04-02
3/4	20	40	64	12	12	52	45	32	32	0,256	25005-06-02
1	25	32	79	15	15	62	51	40	40	0,417	25005-10-02

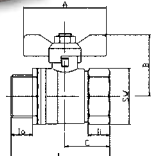

### Key shot-off valves

DN = Nominal diameter  
SW = Width across flats

L = Length  
I = Length/thread

li = Length/thread female  
la = Length/thread male

A = Length lever  
C = 1/2 L

B = lever upper edge to  
midpoint of passage

## Wedge gate valve with flanges

With hand wheel and non-rising stem, both sides with flange PN 10

### Technical characteristics

WP: 16 bar

Housing material: Cast iron GGG50

Coating material: Epoxy, blue

Spindle material: Stainless steel

Seal: NBR

DN mm	DN Inch	Overall length mm	Weight/piece kg	Article no.
40	1 1/2	140	10,00	29602-040
50	2	150	13,00	29602-050
65	2 1/2	170	16,00	29602-065
80	3	180	19,00	29602-080
100	4	190	24,00	29602-100
125	5	200	38,00	29602-125
150	6	210	53,00	29602-150
200	8	230	79,00	29602-200
250	10	250	122,00	29602-250
300	12	270	181,00	29602-300



## Swing check valve

Socket check valve with sealing cap  
F/F, metallic sealing

### Technical characteristics

Material: brass, blank

DN Inch	WP bar	L mm	H mm	SW1 mm	SW2 mm	Article no.
1/2	16	47	48,5	25,0	20,0	25009-04-02
3/4	16	53	56,5	30,0	24,0	25009-06-02
1	16	68	65,0	38,0	27,0	25009-10-02
1 1/4	10	74	78,0	48,0	30,0	25009-12-02
1 1/2	10	86	88,0	54,0	38,0	25009-14-02
2	10	100	103,0	68,5	40,0	25009-20-02
2 1/2	10	104	124,0	83,0	51,5	25009-24-02
3	10	125	137,0	95,5	62,5	25009-30-02
4	10	162	171,0	123,0	81,5	25009-40-02

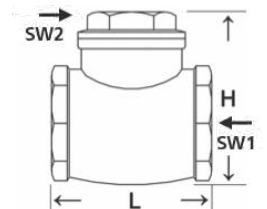

## HINGE BOLT CLAMPS – GrüloClamp SUPRA W2

**Technical characteristics**
**Material:** Bolt 8.8

 band stainless steel X8Cr17 zinc-coated (DIN 1.4016/AISI 430)  
 other parts steel, zinc-coated

**Also available in grades W1 and W4.**

Clamping range mm	Band width mm	Article no.
86 - 91 mm	25 mm	30050-W2-24-091-71436
92 - 97 mm	25 mm	30050-W2-24-097-71436
98 - 103 mm	25 mm	30050-W2-24-103-71436
104 - 112 mm	25 mm	30050-W2-24-112-71436
122 - 130 mm	25 mm	30050-W2-24-130-71436
131 - 139 mm	26 mm	30050-W2-26-139-71436
140 - 148 mm	26 mm	30050-W2-26-148-71436
149 - 161 mm	26 mm	30050-W2-26-161-71436
162 - 174 mm	26 mm	30050-W2-26-174-71436



## PA-RI® HOSE CLAMPS

**Technical characteristics**
**Material:** Steel band galvanised, blue chromated, CR6+ free

**Material thickness:** 1 mm

**Type of screw:** Allen screw

**Screw material:** Steel 8.8, yellow galvanised

**Also available in grades I and VI.**

### GrüloClamp SK - Grade 2, 1-parts | 25 / 1 mm

Nominal size	Clamping range mm	Band width mm	Screw size	Article no.
SK 90	86 – 92	25	M8	31002-25-090
SK 120	116 – 122	25	M8	31002-25-120
SK 144	140 – 146	25	M8	31002-25-144
SK 170	166 – 172	25	M8	31002-25-170



### GrüloClamp SK - Grade 2a, 2-parts | 25 / 1 mm

Nominal size	Clamping range mm	Band width mm	Screw size	Article no.
SK 95	91 – 97	25	M8	31003-25-095
SK 120	116 – 122	25	M8	31003-25-120
SK 170	166 – 172	25	M8	31003-25-170



## WORM DRIVE HOSE CLAMPS – Typ S/12mm | W2

**Technical characteristics**
**Material:** Band and case made of stainless steel 1.4016

Screw Steel, galvanised

**Screw type:** Hexagon head screw SW 7

**Also available in grades W1, W4 and W5.**

Clamping range mm	Band width mm	Article no.
32 - 50 mm	12 mm	30001-W2-12-050-71436
40 - 60 mm	12 mm	30001-W2-12-060-71436
60 - 80 mm	12 mm	30001-W2-12-080-71436
80 - 100 mm	12 mm	30001-W2-12-100-71436
90 - 110 mm	12 mm	30001-W2-12-110-71436
110 - 130 mm	12 mm	30001-W2-12-130-71436
120 - 140 mm	12 mm	30001-W2-12-140-71436
140 - 160 mm	12 mm	30001-W2-12-160-71436





# OUR PRODUCT RANGE AT A GLANCE



## HOSE TECHNOLOGY

technical advice, pressure testing,  
hose line assembly



## HOSE CONNECTION SYSTEMS

couplings, fittings



## FASTENING TECHNOLOGY

hose clamps



## WEAR PROTECTION AND CONVEYOR BELT ENGINEERING



## RUBBER- AND SEALING TECHNOLOGY



## PPE - PERSONAL PROTECTIVE EQUIPMENT



## MRO GOODS



## CHEMICAL PRODUCTS adhesive and sealing material

Grünin **G+L**oske

Magdeburger Str. 1  
D-30880 Laatzen

Fon +49 (0) 51 02 - 91 99 - 01

Fax +49 (0) 51 02 - 91 99 - 90

info@gruelo.de



[www.gruelo.de](http://www.gruelo.de)